

Where Hygiene and Data Security Counts In Wet and Harsh Environments

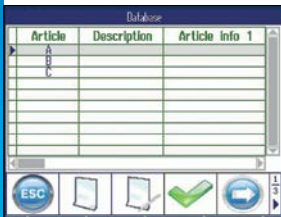

Easy to Clean

The ICS689 product line is designed using the latest hygienic design guidelines including EHEDG or NSF. This includes a double sealed, IP68 and IP69k protected indicator.



Powerful Database

Store up to 5000 articles and materials in the scale-embedded database including relevant parameters such as target weight, tolerances and tare values.

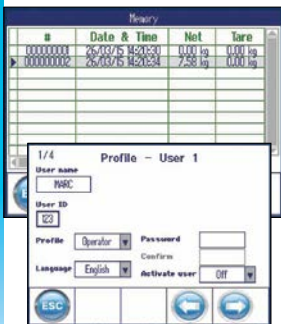

Secure Data Handling

In order to ensure regulatory compliance, weighing data including date/time, article ID or operator ID, is securely stored in a protected memory. Manage access to the scale and weighing data and ensure traceability with multi-level user access rights.



Configurable to your needs

You can choose between three different ways to mount the indicator relative to the platform in order to ensure optimum ergonomics and maximize productivity. A wide variety of platform sizes and capacities up to 600kg are available to best fulfil the requirements of your application.



ICS689 Combi Bench Solutions

Optimize Your Production Processes

The ICS689 compact scale product line features a very rugged design which fulfils the highest hygienic standards. IP68/IP69k protected indicators and hermetic sealed loadcells engineered in conjunction with platform designs conforming to the latest hygienic guidelines, enable efficient and easy cleaning access to all areas. All this makes the ICS689 perfectly suited for wet, harsh or hygienic environments in either the food, pharmaceutical or chemical industry.

- All stainless steel construction designed for hygienic or permanent wet environment
- High pressure water- or steam-jet cleaning
- Patented, double sealed indicators with IP69k
- ColorWeight® for fast and error-free readings
- Various interface options to manage even complex weighing applications
- Advanced data handling with dedicated functions and efficient tools
- Smart weighing counter for improved maintenance

ICS689 Indicators – Technical Data



General Specifications

Applications & Functions	Basic weighing; Average weighing; Over/Under checkweighing; Portioning; Classifying; Totalizing; Totalizing to a target manual filling; Formulation; Speedweigh; Pick Pack; Statistics; Counting; User prompting; User management; Configurable soft keys; Deactivatable hard keys; Alpha numeric keypad; Label printing; Article Database (max. 5,000 entries); Internal Alibi Memory (300,000 transaction); Calibration Log Files
Resolution Applications & Functions	Analog platforms: Up to OIML 2x3,000e/ NTEP 5,000d Digital IDNet or SICSpro platforms: The actual resolution is defined by the respective platform
Display	Color TFT display (320 x 240 pixel); 3 display layouts
Display languages	English, German, French, Italian, Spanish, Chinese, Portuguese, Japanese
Character height	Default layout mode = 25 mm, 3-line info mode = 17 mm
Keypad	Piezo keypad, extremely scratch-resistant, > 10,000,000 keystrokes
Housing	Stainless steel 1.4301, AISI 304
Ingress Protection	IP68 & IP69k
Power Connection	100 – 240 V / 50 – 60 Hz / 300 mA, Length of power cord approx. 2.5 m
Battery (Option)	12 VDC / 2.5 A: Continuous operation with one strain gauge load cell ~ 22 hours; with 4 strain gauge load cells ~ 18 hours. (Duration decreases with installed options). Life time: 500 to 1,000 charging/discharging cycles
Interfaces (Standard and Options)	Standard: 1 x scale interface (Analog, IDNet or SICSpro) 1 x RS232 data interface 3 x Optional interfaces are possible: RS232, RS422/485, USB device, USB host, Ethernet, Digital I/O (4 Inputs + 4 Outputs), IDNet scale, SICSpro scale, Analog scale
Connectable platforms	Up to 4 platforms can be connected. All Analog & SICSpro & IDNet platforms (except F-cell, AWU, GD16-17, PIK)*
Analog scale interface specification	Impedance: $\geq 87.5 \Omega$ (means 1 x 350 Ω ; 4 x 350 Ω), Excitation: 3.3 VDC, Sensitivity: 2 to 3 mV/V Max. Resolution: Up to 2x3,000e (OIML), 30,000d (not approvable) Min. verification scale interval: 0.264 $\mu\text{V/e}$
Temperature Range	Class II, 10 to 30 °C (PBK7-Serie) Class II, 0 to 40 °C (PBK9-Series, PFK9-Series) Class III, -10 to 40 °C (Strain gauge)
Humidity	Max. rel. humidity 85 % for temperatures up to 40 °C
Net / Shipping weight	2 kg / 2.5 kg
Approvals	OIML, NTEP, CE, CSA C US, GMP, EHEDG, NSF (Weights & Measures data is shown in display and indicates if system is approved or not approved)

* depending on the configuration of the indicator: Maximum 2 analog, or 2 IDnet platforms respectively 1 analog plus 1 IDnet

Indicator Platform Combinations



t-Version

For wall mount, bench or desk operation - for all platform sizes.



f-Version

Front mounted indicator on either side of platforms - for A, QA, BB and QB sizes.



c-Version

Column mounted indicators on either side of PBA639 and PBD659 platforms. Cable design secures and protects cables.

Capacities and Readabilities

Platform Size	3 kg	6 kg	12 kg	15 kg	30 kg	60 kg	120 kg	150 kg	300 kg	600 kg	Cable Length for t-version
QA 228 x 228 [mm]	•	•									2.5 m
A 240 x 300 [mm]	•	•	•	•							2.5 m
QB 305 x 305 [mm]			•	•	•	•					2.5 m
BB 300 x 400 [mm]					•	•					2.5 m
B 400 x 500 [mm]					•	•	•	•			2.5 m
BC 500 x 650 [mm]						•	•	•	•		2.5 m
CC 600 x 800 [mm]						•	•	•	•	•	2.5 m

PBD659	3 kg	6 kg	12 kg	15 kg	30 kg	60 kg	120 kg	150 kg	300 kg	600 kg
Approved readability (6,000e)	0.5 g	1 g	2 g	n/a	5 g	10 g	20 g	n/a	50 g	200 g*
Recommended readability at max. resolution (60,000d)	0.05 g	0.1 g	0.2 g	n/a	0.5 g	1 g	2 g	n/a	5 g	10 g
Ingress Protection	IP68 / IP69k									

PBA639	3 kg	6 kg	12 kg	15 kg	30 kg	60 kg	120 kg	150 kg	300 kg	600 kg
Approved readability (3,000e)	1 g	2 g	n/a	5 g	10 g	20 g	n/a	50 g	100 g	200 g
Approved readability (2x3,000e)	n/a	1/2 g	n/a	2/5 g	5/10 g	10/20 g	n/a	20/50 g	50/100 g	100/200 g
Recommended readability at max. resolution (30,000d)	0.1 g	0.2 g	n/a	0.5 g	1 g	2 g	n/a	5 g	10 g	20 g
Ingress Protection	IP68 / IP69k									

*3,000e

Bundle ICS Indicators with PBK9 High Precision Platforms or any other platforms

The PBK9 Series high precision weighing platforms can be directly connected to all ICS indicators (see PBK9 datasheet for detailed specifications of the platforms). For PBK9 platforms of A- and AB-size the item „Factory Approval for SICSpro Scale“ can be ordered for legal-for-trade applications. Indicator and platform will be shipped separately but can easily be connected to an approved weighing system at the place of installation.

You can connect any other analog or digital METTLER TOLEDO platform including floor scales to the ICS Indicators.



Technical Specifications

Platform Dimensions

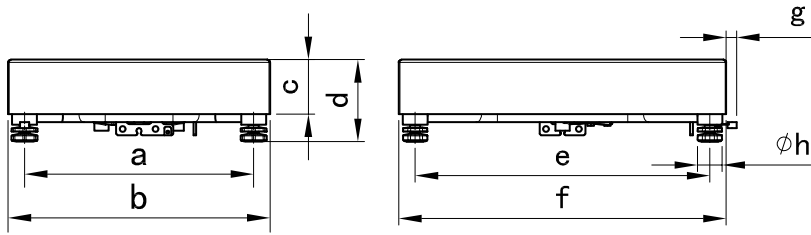

Dimension		a	b	c	d min	e	f	g	h
QA	mm	178	228	70	110	178	228	21	40
A	mm	190	240	70	110	250	300	21	40
QB	mm	255	305	70	110	255	305	21	40
BB	mm	250	300	70	110	350	400	21	40
B	mm	350	400	83	126	450	500	21	40
BC	mm	450	500	90	134	600	650	21	40
CC	mm	550	600	90	134	750	800	21	40
CC[600 kg]	mm	550	600	94	140.5	750	800	21	40

*Dimensions of PBK please see PBK datasheet

Indicator Dimensions

Dimension	[mm]
o	260
p	170
q	114

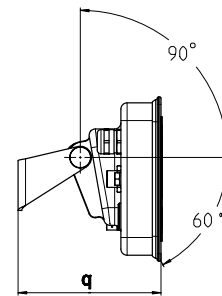
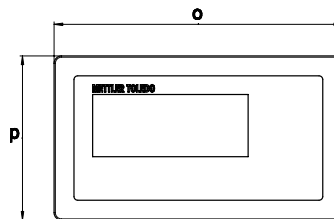

Accessories

I/O Accessories	Relay box for digital I/O including power supply
Covers, Brackets	Protective cover for indicators; Wall bracket; Desk mounting plate
Stands	In many heights and versions
PC Software	Data+ PC management tool
Others	Printers; Interfaces; Cables and much more

METTLER TOLEDO Group

Industrial Division

Local contact: www.mt.com/contacts



Subject to technical changes

© 02/2022 METTLER TOLEDO. All rights reserved

Document No. 30238049 C

MarCom Industrial

www.mt.com

Visit for more information